

9.3 TERMINAL SECTION

A

B

C

D

E

F

Refer to "9.4 CONTROL PANEL SECTION".

*1: Washer and Nut Accessories of VR

*1: Washer and Nut Accessories of VR

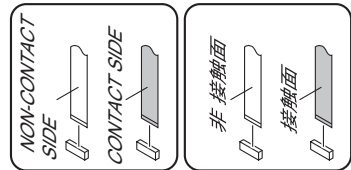
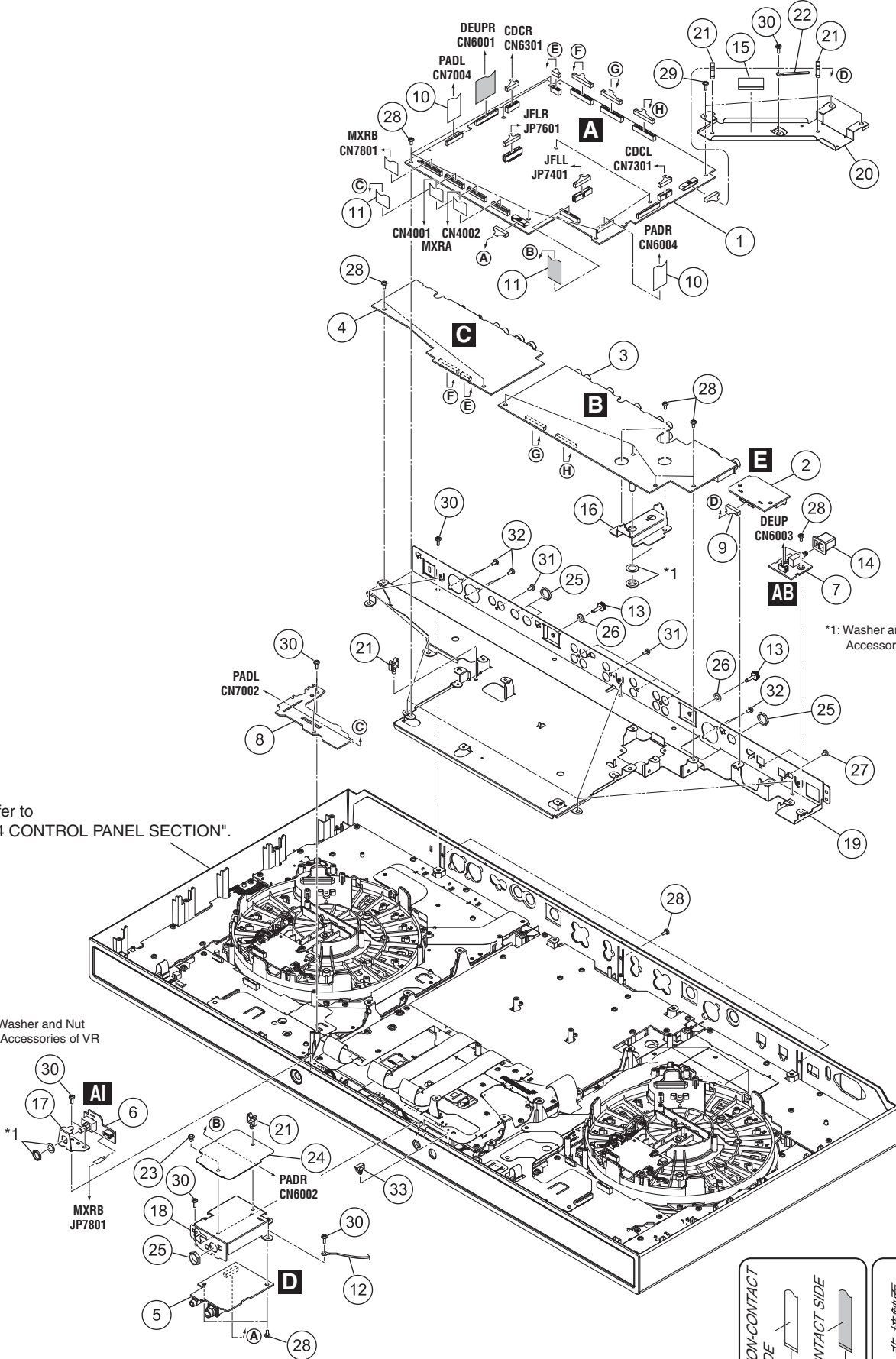

TERMINAL SECTION PARTS LIST

<u>Mark No.</u>	<u>Description</u>	<u>Part No.</u>	
1	MAIN Assy	DWX3535	
2	USBB Assy	DWX3555	A
3	AIJK Assy	DWX3536	
4	AOJK Assy	DWX3537	
5	HPJK Assy	DWX3538	
6	CRFCV Assy	DWX3547	
7	PSWB Assy	DWX3560	
8	STRB Assy	DWX3585	
9	Shielded Conn-Cable	DDA1048	
10	FFC/23P	DDD1658	
11	FFC/25P	DDD1659	B
12	Earth Lead Wire	DE012VC0	
13	Earth Terminal	DKE1015	
14	Power Knob	DAC2306	
15	Sheet/LEG	DEC3534	
16	Bracket/TRM	DNF1933	
17	Stay/CFC	DNF1935	
18	Stay/HP	DNF1937	
19	Plate/MGD	DNH3139	
20	Shield Plate/USB	DNH3156	C
21	Holder	VEC1355	
22	Cord Clamper (Steel)	RNH-184	
23	Push Rivet	XEC3034	
24	Barrier/HP	DEC3548	
25	Nut (M12)	NKX2FNI	
26	Spring Lock Washer	WS40FNI	
27	Screw (M3*5)	DBA1340	
28	Screw	BBZ30P060FTB	
29	Screw	BBZ30P080FTB	D
30	Screw	BPZ30P080FNI	
31	Screw	BPZ30P080FTB	
32	Screw	PPZ30P080FTB	
33	Locking Mini Clamp	DEC2439	

9.3 TERMINAL SECTION

DDJ-SZ/UXJCB and DDJ-RZ/LSYXJ, UXJCB, XJCN are constructed the same except for the following:

Mark	No.	Symbol and Description	DDJ-SZ/UXJCB	DDJ-RZ
A	1	MAIN Assy	DWX3535	DWX3751
	2	USBB Assy	DWX3555	DWX3752
	3	AIJK Assy	DWX3536	DWX3768
	4	AOJK Assy	DWX3537	DWX3769
	5	HPJK Assy	DWX3538	DWX3770
	6	CRFCV Assy	DWX3547	DWX3777
	7	PSWB Assy	DWX3560	DWX3755
	8	STRB Assy	DWX3585	DWX3761

B

9.4 CONTROL PANEL SECTION

C DDJ-SZ/UXJCB and DDJ-RZ/LSYXJ, UXJCB, XJCN are constructed the same except for the following:

For convenience of the system, the part names for the DDJ-RZ are simplified. The part names in parentheses are those for the DDJ-SZ.

Mark	No.	Symbol and Description	DDJ-SZ/UXJCB	DDJ-RZ	Remarks
D	1	DEUP Assy	DWX3548	DWX3760	
	2	KSWB Assy	DWX3549	DWX3757	
	3	SLDB Assy	DWX3550	DWX3758	
	4	DEUPR Assy	DWX3580	DWX3762	
	21	Barrier (Barrier/DEL)	DEC3546	DEC3631	
	22	Barrier (Barrier/DER)	DEC3547	DEC3632	
		SEQL Assy	Not used	DWX3763	No. 34
		QUAL Assy	Not used	DWX3764	No. 35
		QUAR Assy	Not used	DWX3765	No. 36
		SEQR Assy	Not used	DWX3766	No. 37
E		Connector Assy	Not used	PF04PP-B17	No. 38
		Connector Assy	Not used	PF07PP-B17	No. 39
		Crimp Connector	Not used	PF08PP-B12	No. 40
		Crimp Connector	Not used	PF08PP-B17	No. 41
		Barrier	Not used	DEC3630	No. 42
		Stopper	Not used	DNK6532	No. 43
		Binder	Not used	ZCA-SKB90BK	No. 44
	Screw	BPZ30P080FNI	BPZ30P100FTB	No. 45	