

DAP

USER MANUAL

ENGLISH

V1.0

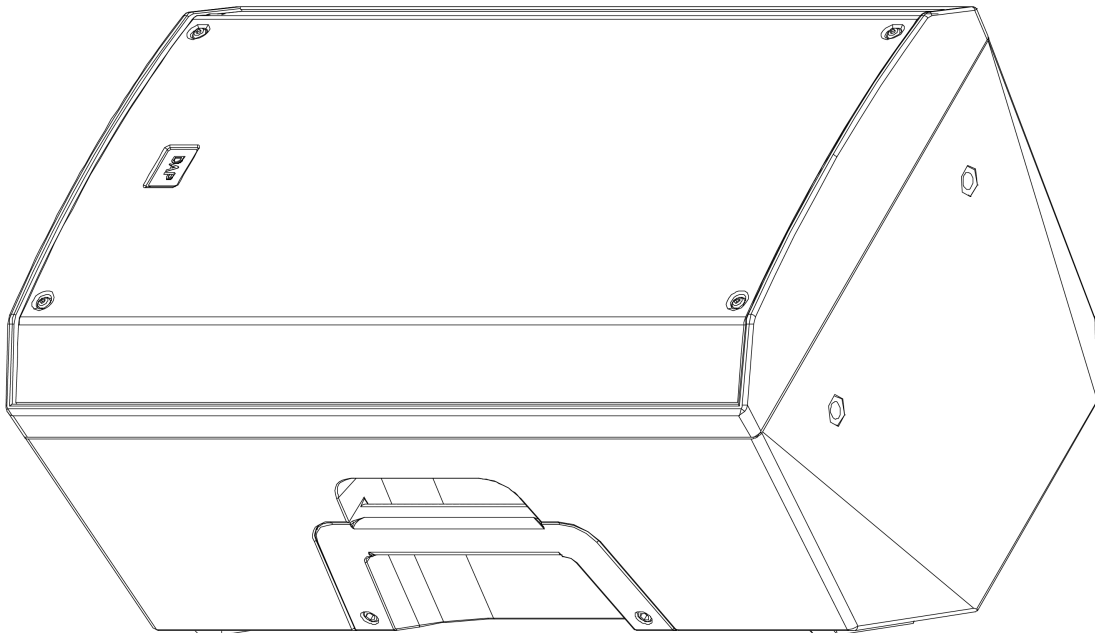

NGA-10A

Product code: D3557

Preface

Thank you for purchasing this DAP product.

The purpose of this user manual is to provide instructions for the correct and safe use of this product.

Keep the user manual for future reference as it is an integral part of the product. The user manual shall be stored at an easily accessible location.

This user manual contains information concerning:

- Safety instructions
- Intended and non-intended use of the device
- Installation and operation of the device
- Maintenance procedures
- Troubleshooting
- Transport, storage and disposal of the device

Non-observance of the instructions in this user manual may result in serious injuries and damage of property.

©2026 DAP. All rights reserved.

No part of this document may be copied, published or otherwise reproduced without the prior written consent of Highlite International.

Design and product specifications are subject to change without prior notice.

For the latest version of this document or other language versions, please visit our website www.highlite.com or contact us at service@highlite.com.

Highlite International and its authorized service providers are not liable for any injury, damage, direct or indirect loss, consequential or economic loss or any other loss arising from the use of, or inability to use or reliance on the information contained in this document.

Highlite International B.V. – Vestastraat 2 – 6468 EX Kerkrade – the Netherlands

Table of contents

1. Introduction	4
1.1. Before Using the Product	4
1.2. Intended Use	4
1.3. Product Lifespan	4
1.4. Text Conventions	4
1.5. Symbols and Signal Words	5
1.6. Symbols on the Information Label	5
2. Safety	6
2.1. Warnings and Safety Instructions	6
2.2. Requirements for the User	8
2.3. Personal Protective Equipment	8
3. Description of the Device	9
3.1. Front View	9
3.2. Back View	10
3.3. Bottom View	10
3.4. Product Specifications	11
3.5. Dimensions	13
3.6. Optional Accessories	13
4. Installation	14
4.1. Safety Instructions for Installation	14
4.2. Personal Protective Equipment	14
4.3. Installation Site Requirements	14
4.4. Mounting Options	14
4.4.1. Installation on a Speaker Stand	15
4.4.2. Installation on a Distance Tube	16
4.4.3. Wall Mounting with a Speaker Bracket	17
4.4.4. Overhead Suspension	19
4.4.5. Overhead Mounting with a Clamp	20
4.5. Connecting to Power Supply	21
5. Setup	22
5.1. Warnings and Precautions	22
5.2. Setup Example	22
5.3. Connecting a Microphone	23
5.4. Connecting a Line-Level Device	23
5.5. Connecting a Hi-Z Source Device	23
5.6. Connecting to a Streaming Source Device	23
5.7. Connecting Multiple Devices	24
6. Operation	25
6.1. Safety Instructions for Operation	25
6.2. Switching On and Off	25
6.3. BT Connection	25
6.3.1. Pairing with a Streaming Source Device	26
6.3.2. Linking to Another Device	26
6.4. Control Modes	27
6.5. Adjusting the Gain	27
6.6. Start-up	27
6.7. Menu Overview	28
6.8. Main Menu Options	29
6.8.1. Input Settings	29
6.8.2. User Mode	30
6.8.3. Subwoofer Matching	30
6.8.4. Equalizer	31
6.8.5. Delay	31
6.8.6. User Presets	32
6.8.6.1. Saving or Loading a User Preset	32
6.8.7. Standby Amplifier	33
6.8.8. Speaker and Device Information	33

6.8.9. Factory Settings Reset.....	33
6.8.10. Onscreen Keyboard.....	34
6.9. App Control.....	35
6.9.1. Connecting the Device.....	35
6.9.2. Main Menu.....	36
6.9.2.1. Save/Load.....	37
6.9.2.1.1. Save a User Preset.....	37
6.9.2.1.2. Load a User Preset.....	37
6.9.2.1.3. Delete a User Preset.....	38
6.9.2.2. EQ Setting.....	38
7. Troubleshooting.....	40
8. Maintenance.....	41
8.1. Safety Instructions for Maintenance.....	41
8.2. Preventive Maintenance.....	41
8.2.1. Basic Cleaning Instructions.....	41
8.3. Corrective Maintenance.....	42
8.3.1. Replacing the Fuse.....	42
9. Deinstallation, Transportation and Storage.....	43
9.1. Instructions for Deinstallation.....	43
9.2. Instructions for Transportation.....	43
9.3. Storage.....	43
10. Disposal.....	43
11. Approval.....	43

1. Introduction

1.1. Before Using the Product



Important

Read and follow the instructions in this user manual before installing, operating or servicing this product.

The manufacturer will not accept liability for any resulting damages caused by the non-observance of this manual.

After unpacking, check the contents of the box. If any parts are missing or damaged, contact your Highlite International dealer.

Your shipment includes:

- DAP NGA-10A
- Schuko to IEC power cable (1,5 m)
- User manual

Figure 1

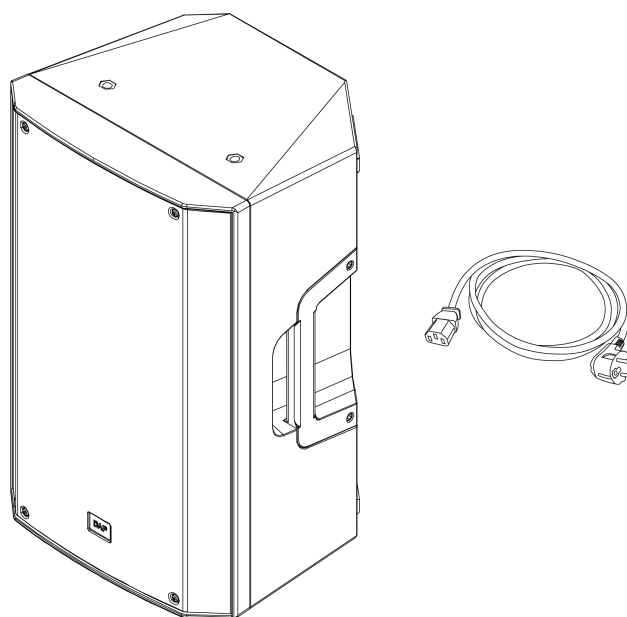

1.2. Intended Use

This device is intended for professional use as an active loudspeaker. It can be installed only indoors. This device is not suitable for households.

Any other use, not mentioned under intended use, is regarded as non-intended and incorrect use.

1.3. Product Lifespan

This device is not designed for permanent operation.

Disconnect the device from the electrical power supply when the device is not in operation. This will reduce the wear and will improve the lifespan of the device.

1.4. Text Conventions

Throughout the user manual the following text conventions are used:

- References: References to parts of the device are in bold lettering, for example: "turn the **adjustment handle (05)**". References to chapters are hyperlinked
- 0–255: Defines a range of values
- Notes: **Note:** (in bold lettering) is followed by useful information or tips

1.5. Symbols and Signal Words

Safety notes and warnings are indicated throughout the user manual by safety signs.

Always follow the instructions provided in this user manual.



DANGER

Indicates an imminently hazardous situation which, if not avoided, will result in death or serious injury.



WARNING

Indicates a potentially hazardous situation which, if not avoided, could result in death or serious injury.



CAUTION

Indicates a potentially hazardous situation, which, if not avoided, may result in minor or moderate injury.



Attention

Indicates important information for the correct operation and use of the product.



Important

Read and observe the instructions in this document.



Electrical hazard



Provides important information about the disposal of this product.

1.6. Symbols on the Information Label

This product is provided with an information label. The information label is located on the side of the device.

The information label contains the following symbols:



This device is designed for indoor use.



This device shall not be treated as household waste.



This device falls under IEC protection class I.



Warning: Risk of electric shock. Do not open.

Warning: To reduce the risk of fire or electric shock do not expose this equipment to rain or moisture.

2. Safety



Important
Read and follow the instructions in this user manual before installing, operating or servicing this product.

The manufacturer will not accept liability for any resulting damages caused by the non-observance of this manual.

2.1. Warnings and Safety Instructions



DANGER
Danger for children

For adult use only. The device must be installed beyond the reach of children.

- Do not leave any parts of the packaging (plastic bags, polystyrene foam, nails, etc.) within the reach of children. Packaging material is a potential source of danger for children.



DANGER
Electric shock caused by dangerous voltage inside

There are areas inside the device where dangerous touch voltage may be present.

- Do not open the device or remove any covers.
- Do not operate the device if the covers or the housing are open. Before operation, check if the housing is firmly closed and all screws are tightly fastened.
- Disconnect the device from the electrical power supply before service and maintenance, and when the device is not in use.



DANGER
Electric shock caused by short-circuit

This device falls under IEC protection Class I.

- Make sure that the device is electrically connected to ground (earth). Connect the device only to a socket-outlet with a ground (earth) connection.
- Do not cover the ground (earth) connection.
- Do not bypass the thermostatic switch or fuses.
- Replace fuses only with the same type and rating.
- Do not let the power cable come into contact with other cables. Handle the power cable and all connections with the mains with caution.
- Do not modify, bend, mechanically strain, put pressure on, pull or heat up the power cable.
- Make sure that the power cable is not crimped or damaged. Examine the power cable periodically for any defects.
- Do not immerse the device in water or other liquids. Do not install the device in a location where flooding may occur.
- Do not use the device during thunderstorms. Disconnect the device from the electrical power supply immediately.

**WARNING**
Stability hazard

The device may fall if it is not mounted according to the instructions in this user manual, causing personal injury and material damage.

If stacked installation is used:

- Make sure that the device is placed on a flat and level surface.
- Do not place objects on the top of the device. These objects may fall and cause injury.
- Do not move the device to adjust the position of the device.

**Attention**
Power supply

- Before connecting the device to the power supply, make sure that the current, voltage and frequency match the input voltage, current and frequency specified on the information label on the device.
- Make sure that the cross-sectional area of the extension cords and power cables is sufficient for the required power consumption of the device.

**Attention**
General safety

- Do not shake the device. Avoid brute force when installing or operating the device.
- If the device is dropped or struck, disconnect the device from the electrical power supply immediately.
- If the device is exposed to extreme temperature variations (e.g. after transportation), do not switch it on immediately. Let the device reach room temperature before switching it on, otherwise it may be damaged by the formed condensation.
- If the device fails to work properly, discontinue use immediately.

**Attention**
For professional use only
This device must be used only for the purposes it is designed for.

This device is designed to be used as an active loudspeaker. Any incorrect use may lead to hazardous situations and result in injuries and material damage.

- This device is not suitable for households.
- This device does not contain user-serviceable parts. Unauthorized modifications to the device will render the warranty void. Such modifications may result in injuries and material damage.

**Attention**
Before each use, examine the device visually for any defects.

Make sure that:

- There are no deformations on housings, fixings and installation points.
- The power cables are not damaged and do not show any material fatigue.

**Attention****Do not expose the device to conditions that exceed the rated IP class conditions.**

This device is IP20 rated. IP (Ingress Protection) 20 class provides protection against solid objects greater than 12 mm, such as fingers, and no protection against harmful ingress of water.

2.2. Requirements for the User

This product may be used by ordinary persons. Installation and maintenance may be carried out by ordinary persons. Service shall be carried out only by instructed or skilled persons. Contact your Highlite International dealer for more information.

Instructed persons have been instructed and trained by a skilled person, or are supervised by a skilled person, for specific tasks and work activities associated with the installation, service and maintenance of this product, so that they can identify risks and take precautions to avoid them.

Skilled persons have training or experience, which enables them to recognize risks and avoid hazards associated with the installation, service and maintenance of this product.

Ordinary persons are all persons other than instructed persons and skilled persons. Ordinary persons include not only users of the product but also any other persons that may have access to the device or who may be in the vicinity of the device.

2.3. Personal Protective Equipment

During installation, deinstallation and rigging wear personal protective equipment in compliance with the national and site-specific regulations.

3. Description of the Device

The DAP NGA-10A is a compact active loudspeaker designed for versatile audio applications. It features a 10" woofer paired with a 1.4" compression driver, delivering a frequency response of 48–20000 Hz (-10 dB). The system is powered by a 1000 W RMS Class-D amplifier and includes a built-in DSP engine with 4 selectable user modes.

The rear panel offers 2 combo XLR/jack inputs. One of these accepts both mic and line-level signals, while the other supports Hi-Z sources such as electric guitars. A balanced XLR output is available for linking to additional speakers; this output sums both analogue inputs and includes the BT signal.

Further audio shaping is possible via a flexible crossover section with multiple crossover frequency options, as well as a 3-band equalizer with adjustable frequency, Q-factor and EQ type. Delay settings and user-defined EQ presets can be stored directly on the device.

BT 5.3 connectivity enables wireless audio streaming and supports True Wireless Stereo (TWS) pairing. In addition, the NGA-10A can be remotely controlled via a dedicated app, allowing access to output gain, 3-band EQ, speaker name and stored presets.

Despite its feature set, the unit remains lightweight and portable, making it suitable for both fixed installations and mobile applications.

3.1. Front View

Figure 2

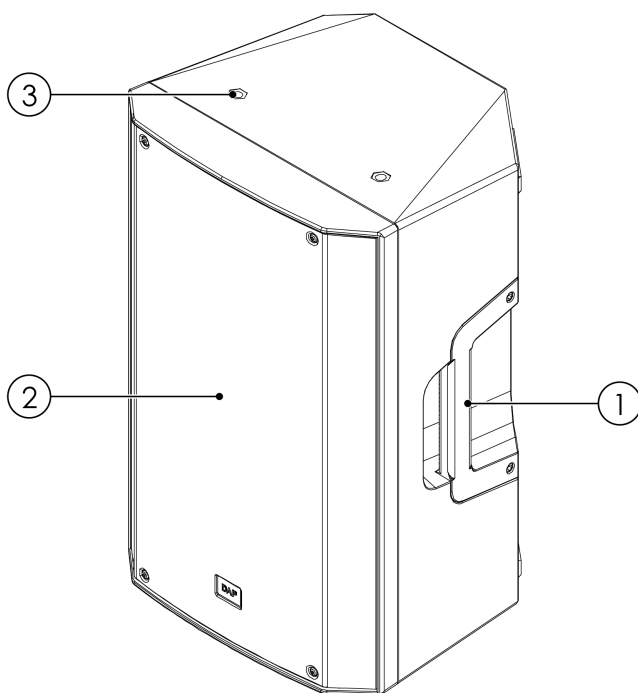

- 01) 2 x carrying handle
- 02) Speaker grille
- 03) 2 x top mounting opening (M10)

3.2. Back View

Figure 3

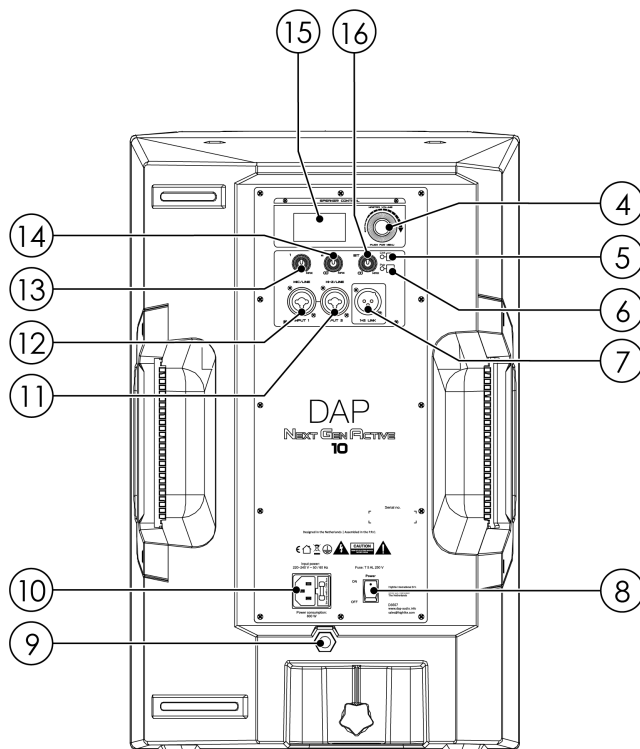

- 04) Master volume control & control knob
- 05) BT link button and LED indicator
- 06) BT pairing button and LED indicator
- 07) 3-pin XLR link connector OUT (1+2 LINK)
- 08) Power switch (On/Off)
- 09) Back mounting opening (M10)
- 10) IEC power connector IN (with integrated fuse holder, fuse 5A)
- 11) Combined (3-pin XLR/6,3 mm jack) Hi-Z/line connector IN (INPUT 2)
- 12) Combined (3-pin XLR/6,3 mm jack) mic/line connector IN (INPUT 1)
- 13) Mic/line-level gain control
- 14) Hi-Z/line-level gain control
- 15) TFT screen
- 16) BT gain control

3.3. Bottom View

Figure 4

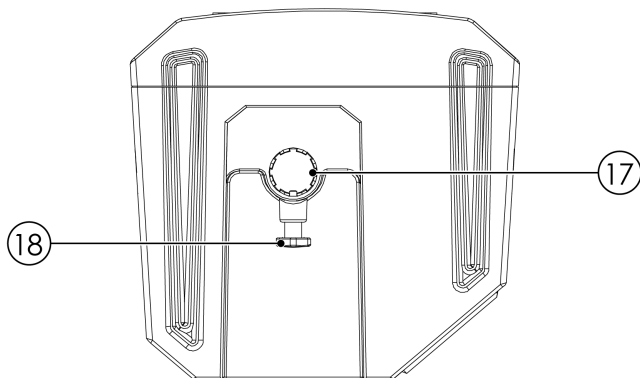

- 17) Mounting opening (Ø 35 mm)
- 18) Screw knob

3.4. Product Specifications

Model:	NGA-10A
Inputs:	
Mono inputs	2
Mono input connector	3-pin XLR / TS unbalanced 6,3 mm
Outputs:	
Low driver power	650 W
High driver power	350 W
Power amplifier RMS output	1000 W
Power amplifier peak output	2000 W
Main outputs	1
Main output connector	3-pin XLR
Audio Specifications:	
THD level %	< 0,15 %
Signal-to-noise ratio	> 85 dB
Amp technology	Class D
Speaker system	2-way
Speaker sensitivity (1 W/1 m)	95 dB
Maximum SPL at 1 m	126 dB
Frequency response (-3 dB) minimum	54 Hz
Frequency response (-3 dB) maximum	20000 Hz
Frequency response (-10 dB) minimum	48 Hz
Frequency response (-10 dB) maximum	20000 Hz
Crossover frequency (High)	3000 Hz
Woofer diameter	10 "
Woofer voice coil diameter	2,5 "
Woofer magnet type	Ferrite
Compression driver diameter	1 "
Compression driver voice coil	1,4 "
Compression driver magnet type	Ferrite
Dispersion angle (horizontal)	90°
Dispersion angle (vertical)	60°
Control and Programming:	
Control mode	BT
Display	TFT
Display size	1,9 "
Electrical Specifications and Connections:	
Power supply	220-240 V AC 50/60 Hz
Power consumption	800 W
Fuse	5 A
Power connector IN	IEC

Mechanical Specifications:

Height	528 mm
Width	334 mm
Depth	313 mm
Material	Polypropylene
Color	Black
Weight	12,52 kg
IP rating	IP20 (indoor use only)

Product Properties:

Pole mount	35 mm
Electronic protection	Clip limiter / overload / thermal
LED indicators	BT pairing
Rotatable horn	No
Useable as monitor/wedge	Yes
Speaker grille material	Steel
Speaker handle positions	Left side / right side

Rigging:

Rigging options	Flying
Rigging eye thread	M10

Thermal Specifications:

Maximum ambient temperature	50 °C
Minimum ambient temperature	-20 °C

Included Items:

Included cables	IEC cable
-----------------	-----------

Sound Editing:

Output delay (max.)	20,8 ms
---------------------	---------

3.5. Dimensions

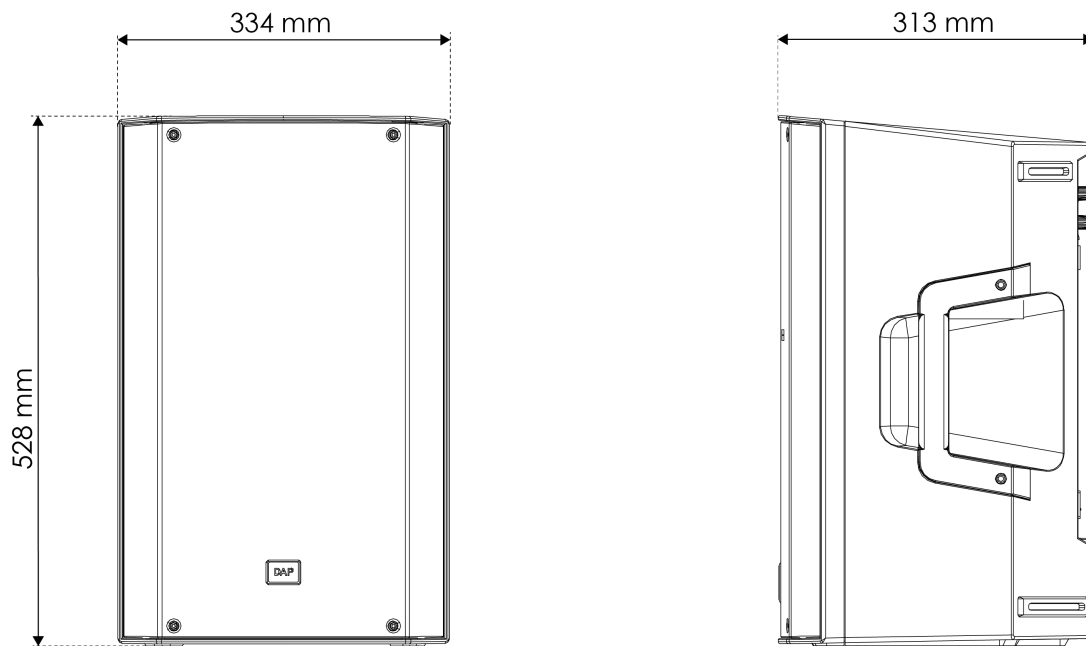

Figure 5

3.6. Optional Accessories

You can additionally purchase the following accessories:

- [D8436](#) Speaker hanging eye/ring 10mm (Black)
- [D8600](#) Mammoth speaker stand
- [D8602](#) Mammoth speaker stand with baseplate
- [D8610](#) Mammoth distance tube 35mm
- [D8611](#) Mammoth distance tube M20
- [D8615](#) Mammoth Speaker wall mount
- [90441](#) Schuko to IEC cable 3m
- [92022](#) IEC C13 to Schuko Male 5m

Contact your Highlite International dealer for more information.

4. Installation

4.1. Safety Instructions for Installation

**WARNING**

Incorrect installation can cause serious injuries and damage of property.

If trussing systems are used, installation must be carried out only by instructed or skilled persons.

Follow all applicable European, national and local safety regulations concerning rigging and trussing.

**WARNING**

Stability hazard

The device may fall if it is not mounted according to the instructions in this user manual, causing personal injury and material damage.

4.2. Personal Protective Equipment

During installation, deinstallation and rigging wear personal protective equipment in compliance with the national and site-specific regulations.

4.3. Installation Site Requirements

- The device can be used only indoors.
- The maximum ambient temperature $t_a = 50\text{ °C}$ must never be exceeded.
- The relative humidity must not exceed 50 % with an ambient temperature of 50 °C.

4.4. Mounting Options

The device can be mounted on a speaker stand, on a distance tube, suspended from an overhead structure with cables or chains, or mounted to a truss with a clamp (see [3.6. Optional Accessories](#) on page 13).

The device has a **mounting opening (17)** on the bottom for upright installation on a speaker stand or distance tube. The device also has 2 **top mounting openings (03)** and 1 **backside mounting opening (09)** for suspended installation.

4.4.1. Installation on a Speaker Stand



WARNING
Stability hazard

The device may fall if it is mounted on a speaker stand, causing personal injury or death.

- Make sure that the device is safely mounted on the speaker stand.
- Do not place objects on the top of the device when it is mounted on a speaker stand. These objects may fall and cause injury.
- Make sure that the speaker stand can support the weight of the device.

To mount the device on a speaker stand (see [3.6. Optional Accessories](#) on page 13), follow the steps below:

- 01) Place the speaker stand on a level stable surface.
- 02) Fully extend the legs of the speaker stand.
- 03) Lift the device above the speaker stand.
- 04) Place the device on top of the speaker stand so that the tube of the stand fits in the **mounting opening (17)**.
- 05) Turn the **screw knob (18)** clockwise to secure the connection.

Figure 6

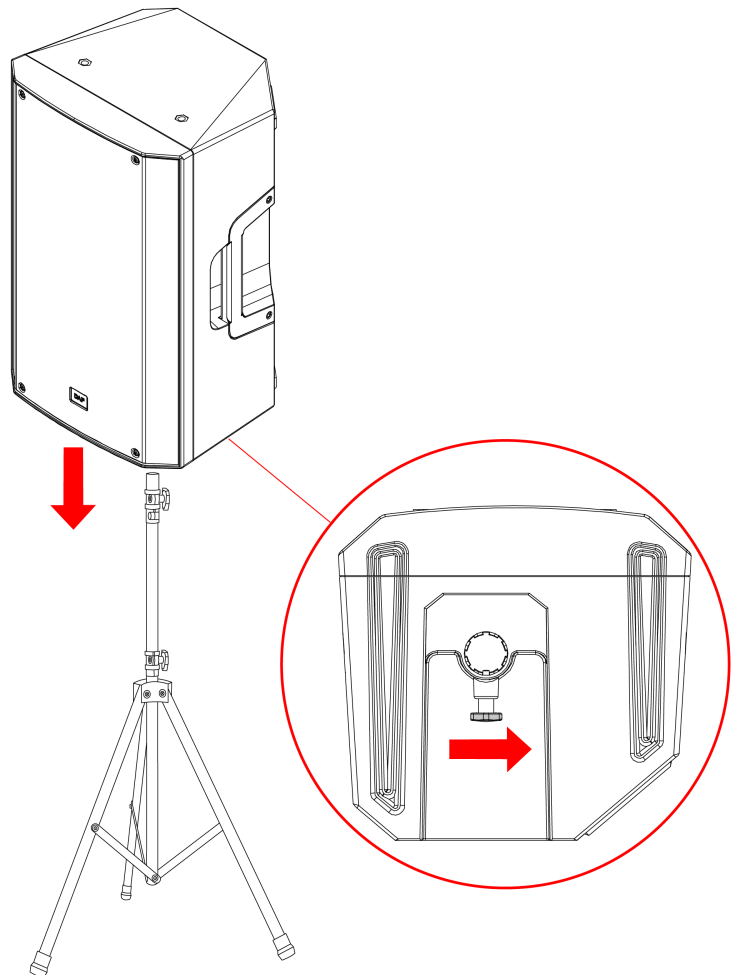

4.4.2. Installation on a Distance Tube



WARNING
Stability hazard

The device may fall if it is mounted on a distance pole, causing personal injury or death. The device is for use only with the stands that are recommended in this user manual.

- Make sure that the device is safely mounted on a distance pole.
- Do not place objects on the top of the device when it is mounted on a distance pole. These objects may fall and cause injury.

You can stack the device on top of a subwoofer with a distance tube (see [3.6. Optional Accessories](#) on page 13).

To mount the device on a distance tube, follow the steps below:

- 01) Place the subwoofer on a level stable surface.
- 02) Insert the distance tube into the threaded mounting opening on the top of the subwoofer.
- 03) Turn the distance tube clockwise to secure the distance tube to the subwoofer.
- 04) Lift the NGA-10A above the distance tube.
- 05) Place the device on top of the distance tube so that the tube fits in the **mounting opening (17)**.
- 06) Turn the **screw knob (18)** clockwise to secure the connection.

Figure 7

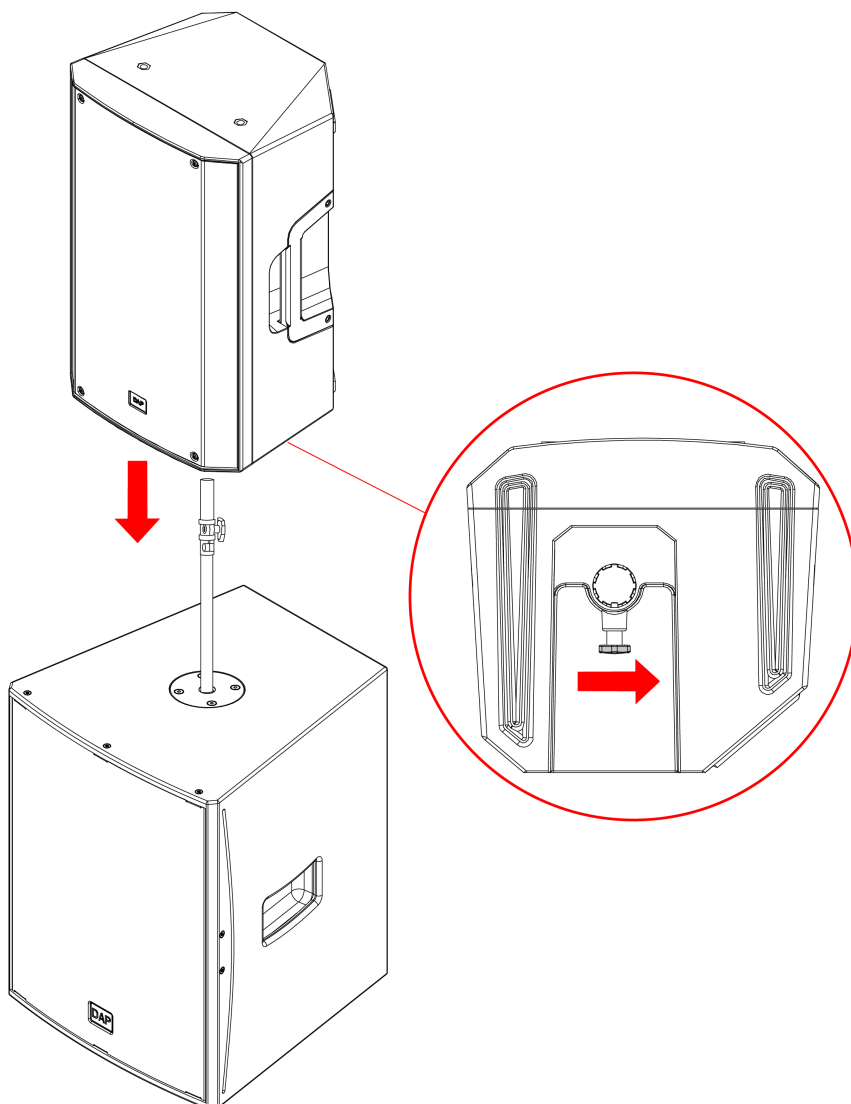

4.4.3. Wall Mounting with a Speaker Bracket

**CAUTION**

Restrict the access under the work area during installation/deinstallation.

You can mount the device to a wall with a speaker bracket (see [3.6. Optional Accessories](#) on page 13).

To install the device on a wall, you need the following:

- a drill
- a drill bit (for wood or concrete)
- 6 anchors (if applicable)
- 6 screws
- a speaker bracket

Notes:

- Make sure that the location where you will drill the mounting holes is free of any obstructions such as pipe work, ducting or wiring.
- Do not drill into mortar joints. Screws installed in mortar joints cannot safely support the weight of the device.

To mount the device on a wall with a speaker bracket, follow the steps below:

- 01) Hold the speaker bracket against the wall and mark the mounting locations.
- 02) Drill holes at the marked locations.
- 03) Insert anchors into the drilled holes, if applicable.

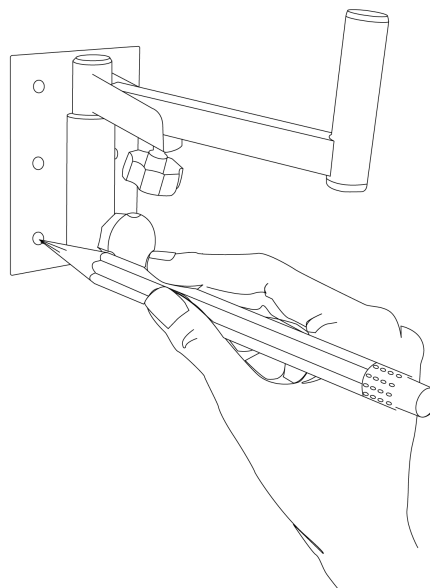
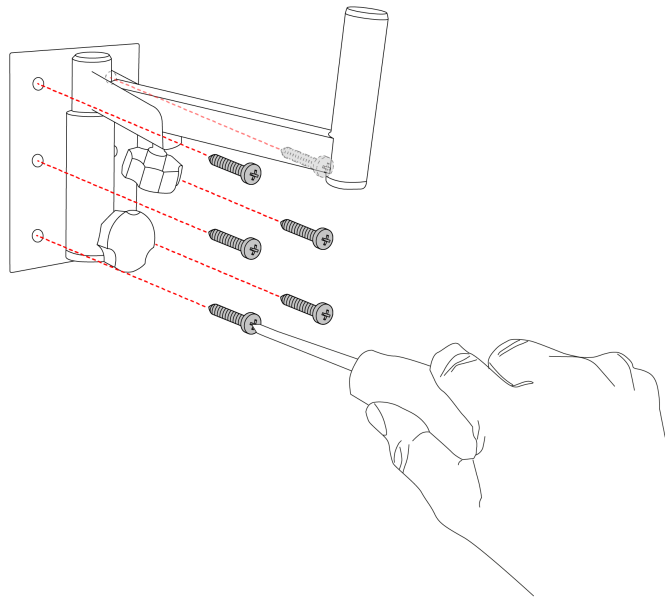

Figure 8

- 04) Hold the speaker bracket at the mounting location.
- 05) Insert and tighten the screws into the drilled holes to fasten the speaker bracket to the wall.

Figure 9



- 06) Lift the NGA-10A above the speaker bracket.
- 07) Place the device on top of the speaker bracket tube so that the tube of the speaker bracket fits in the **mounting opening (17)**.
- 08) Turn the **screw knob (18)** clockwise to secure the connection.

Figure 10

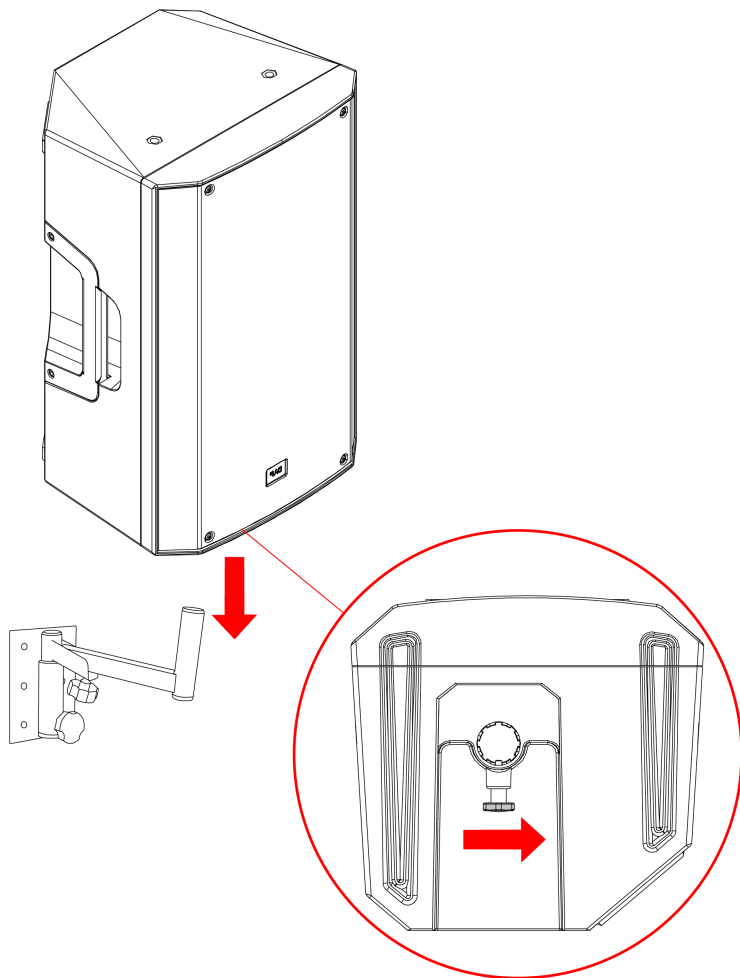

4.4.4. Overhead Suspension



CAUTION

Restrict the access under the work area during installation/deinstallation.

You can suspend the device on an overhead structure from the 2 **top mounting openings (03)** and the **back mounting opening (09)**, using 3 hanging eyes (see [3.6. Optional Accessories](#) on page 13).

To suspend the device, follow the steps below:

- 01) Insert the 3 hanging eyes (M10, thread length: min 15 mm, max 30 mm) in the 2 **top mounting openings (03)** and the **back mounting opening (09)**.
- 02) Turn the 3 hanging eyes clockwise to tighten them. Make sure that the thread is fully used but do not overtighten them.

Figure 11

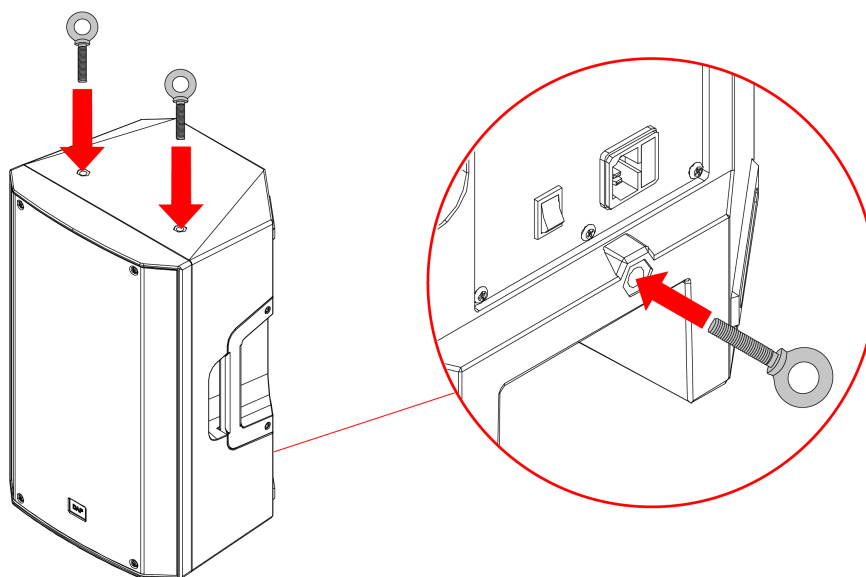

- 03) Suspend the device on the overhead structure with suitable suspension cables or chains.
- 04) Adjust the length of the suspension cable or chain attached to the **back mounting opening (09)** to adjust the tilt of the device.
- 05) Secure the device to the overhead structure with an appropriate secondary attachment, for example a safety cable.

Figure 12

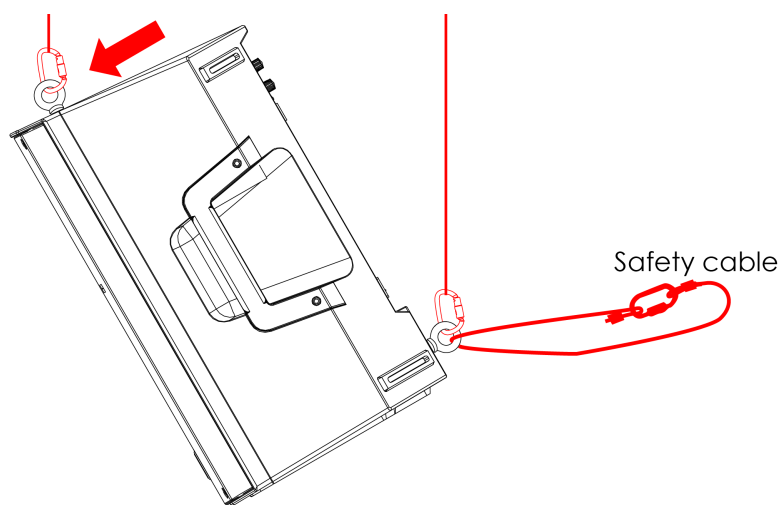

4.4.5. Overhead Mounting with a Clamp



CAUTION

Restrict the access under the work area during installation/deinstallation.

You can temporarily mount the NGA-10A with 2 clamps to a truss. You also need 1 hanging eye (see [3.6. Optional Accessories](#) on page 13) to secure the device with an appropriate secondary attachment, for example a safety cable.

To mount the device, follow the steps below:

- 01) Insert 2 spigots (M10, thread length: min 15 mm, max 30 mm) in the 2 **top mounting openings (03)**.
- 02) Turn the 2 spigots clockwise to tighten them. Make sure that you do not overtighten them.
- 03) Insert the hanging eye (M10, thread length: min 15 mm, max 30 mm) in the **back mounting opening (09)**.
- 04) Turn the hanging eye clockwise to tighten it. Make sure that the thread is fully used but do not overtighten it.

Figure 13

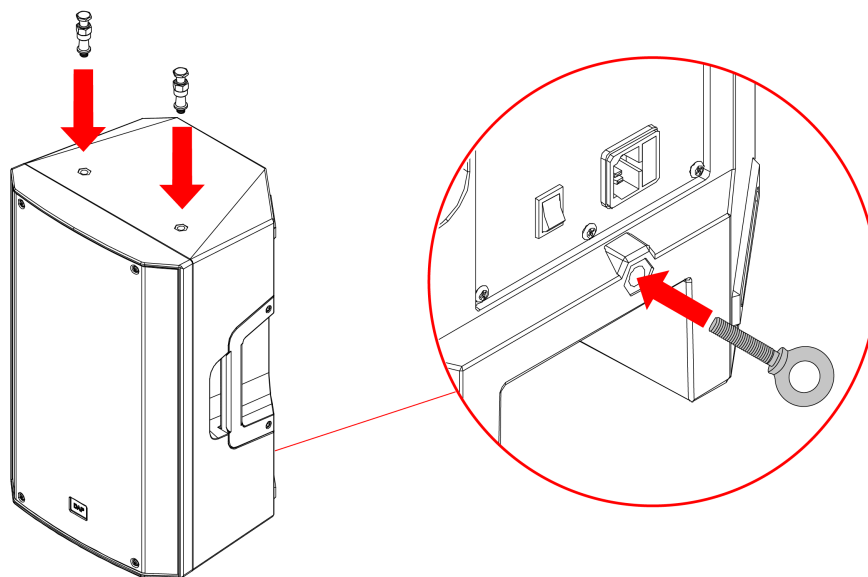

- 05) Attach 2 clamps to the overhead structure.
- 06) Lift the device under the clamps and insert the spigots into the sockets on the base of the clamps.
- 07) Secure the device to the overhead structure with an appropriate secondary attachment, for example a safety cable.

Figure 14

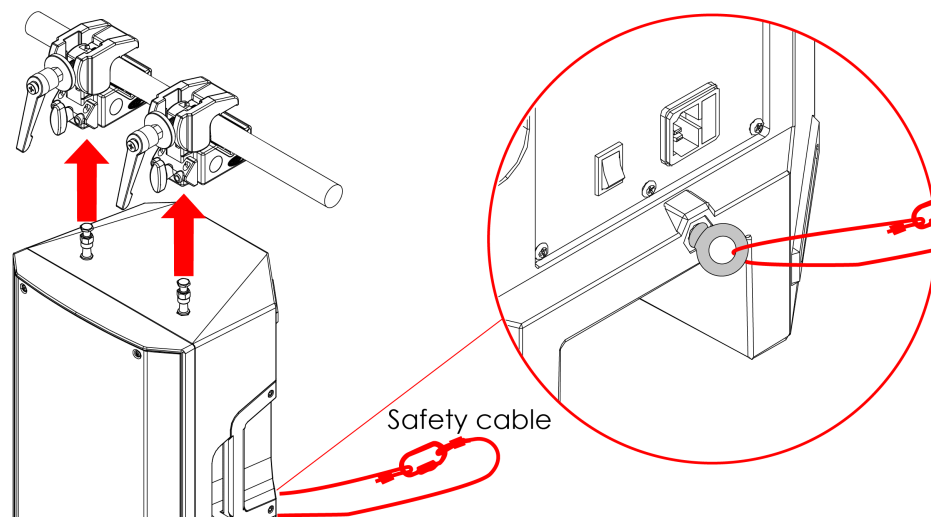

4.5. Connecting to Power Supply



DANGER
Electric shock caused by short-circuit

The device accepts AC mains power at 100–240 V and 50/60 Hz. Do not supply power at any other voltage or frequency to the device.

This device falls under IEC protection class I. Make sure that the device is always electrically connected to the ground (earth).

Before connecting the device to the socket-outlet:

- Make sure that the power supply matches the input voltage specified on the information label on the device.
- Make sure that the socket-outlet has a ground (earth) connection.

Connect the device to the socket-outlet with the power plug. Do not connect the device to a dimmer circuit, as this may damage the device.

5. Setup

5.1. Warnings and Precautions



Attention

Make sure that all inputs and outputs are connected before turning the power on.
Turn the power off before disconnecting inputs or outputs.

5.2. Setup Example

You can connect the following external devices to the NGA-10A:

- a microphone (see [5.3. Connecting a Microphone](#))
- a line-level device (see [5.4. Connecting a Line-Level Device](#))
- a Hi-Z source (see [5.5. Connecting a Hi-Z Source Device](#))
- a streaming source device (see [5.6. Connecting to a Streaming Source Device](#))

Note:

If you pair 2 NGA-10A devices, you can use them in TWS (True Wireless Stereo) mode. The speaker connected to the sound-streaming device outputs the left channel and the 2nd speaker outputs the right channel.

Figure 15

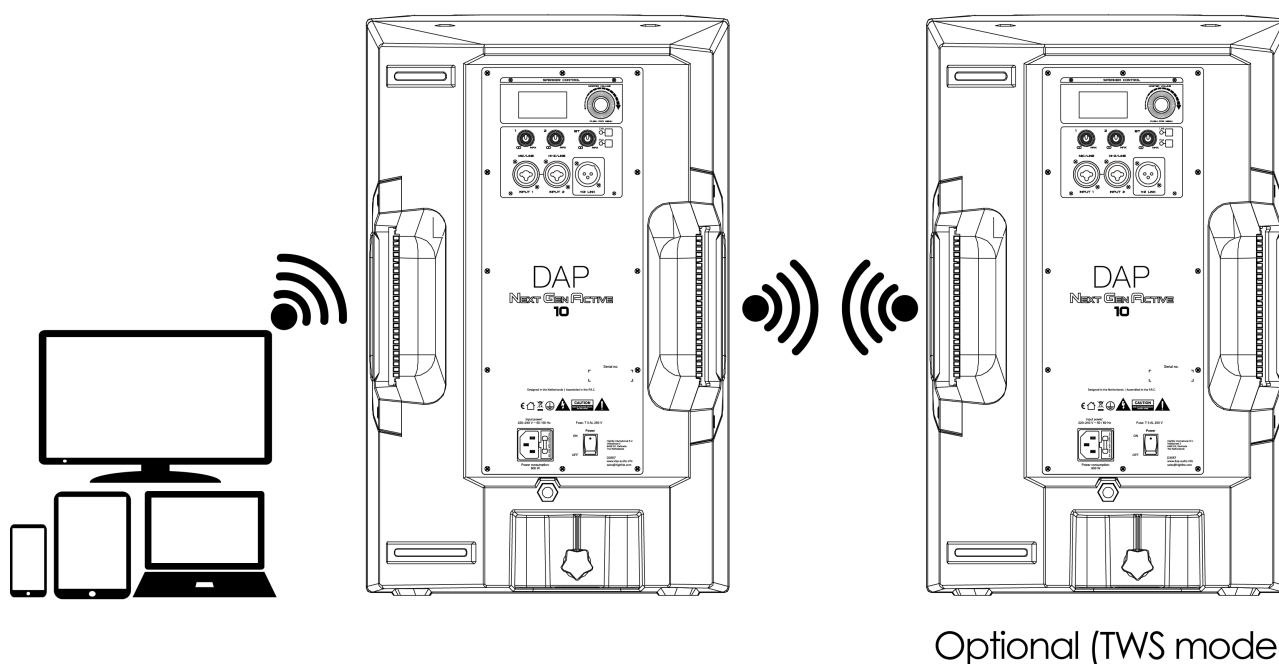

5.3. Connecting a Microphone

You can connect a microphone to the **combined mic/line connector IN (12)** of the NGA-10A.

To connect a microphone to the NGA-10A, follow the steps below:

- 01) Switch on the NGA-10A.
- 02) Make sure that the **mic/line-level gain control (13)** is turned down.
- 03) Set the **combined mic/line connector IN (12)** to the mic setting (see [6.8.1. Input Settings](#) on page 29).
- 04) Connect a microphone to the **combined mic/line connector IN (12)**.
- 05) Switch on the microphone.
- 06) Adjust the **mic/line-level gain control (13)** as necessary.

5.4. Connecting a Line-Level Device

You can connect a line-level device, such as a DJ mixer, to the **combined mic/line connector IN (12)** or the **combined Hi-Z/line connector IN (11)** of the NGA-10A.

To connect a line-level device to the NGA-10A, follow the steps below:

- 01) Switch on the NGA-10A.
- 02) Make sure that the **mic/line-level gain control (13)** or the **Hi-Z/line-level gain control (14)** is turned down.
- 03) Set the **combined mic/line connector IN (12)** to the line setting (see [6.8.1. Input Settings](#) on page 29) or set the **combined Hi-Z/line connector IN (11)** to Hi-Z mode OFF (see [6.8.1. Input Settings](#) on page 29).
- 04) Connect a line-level device to the **combined mic/line connector IN (12)** or the **combined Hi-Z/line connector IN (11)**.
- 05) Switch on the line-level device.
- 06) Adjust the **mic/line-level gain control (13)** or the **Hi-Z/line-level gain control (14)** as necessary.

5.5. Connecting a Hi-Z Source Device

You can connect a Hi-Z (high impedance) device, such as an electric guitar, to the **combined Hi-Z/line connector IN (11)** of the NGA-10A.

To connect a Hi-Z source device to the NGA-10A, follow the steps below:

- 01) Switch on the NGA-10A.
- 02) Make sure that the **Hi-Z/line-level gain control (14)** is turned down.
- 03) Set the **combined Hi-Z/line-level connector IN (11)** to Hi-Z mode ON (see [6.8.1. Input Settings](#) on page 29).
- 04) Connect a Hi-Z source device to the **combined Hi-Z/line connector IN (11)**.
- 05) Switch on the Hi-Z source device.
- 06) Adjust the **Hi-Z/line-level gain control (14)** as necessary.

5.6. Connecting to a Streaming Source Device

You can connect a streaming source device, such as a smartphone or tablet, to the NGA-10A.

To connect a streaming source device to the NGA-10A, follow the steps below:

- 01) Switch on the NGA-10A.
- 02) Make sure that the **BT gain control (16)** is turned down.
- 03) Pair a streaming source device to the NGA-10A (see [6.3.1. Pairing with a Streaming Source Device](#) on page 26).
- 04) Adjust the **BT gain control (16)** as necessary.

5.7. Connecting Multiple Devices

You can connect 2 or more NGA-10A sets in a daisy-chain or connect the NGA-10A to another speaker such as a subwoofer.

- 01) Use a 3-pin XLR cable to connect the **3-pin XLR link connector OUT (07)** of the 1st device to the **combined Hi-Z/line connector IN (11)** or **combined mic/line connector IN (12)** of the 2nd device, or to the connector IN of a subwoofer.
- 02) Adjust the subwoofer cutoff frequency off the NGA-10A if necessary (see [6.8.3. Subwoofer Matching](#) on page 30).
- 03) Repeat step 1 to connect more devices in one setup.

Figure 16

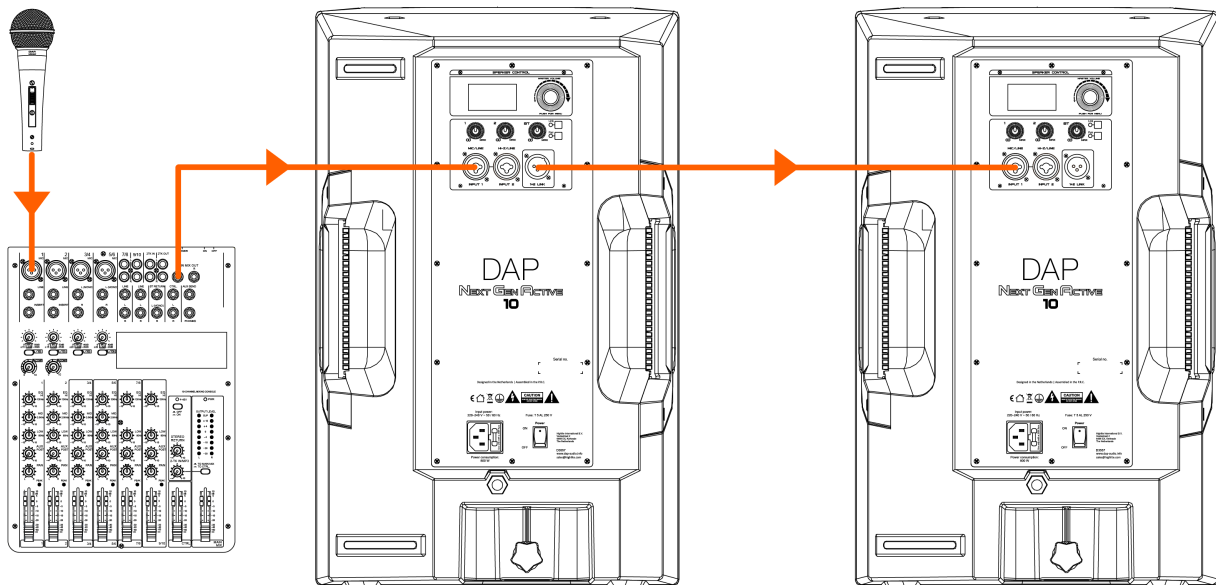

Note:

The signal of a source device connected to the NGA-10A is sent to the **3-pin XLR link connector OUT (07)** of the NGA-10A unaltered. Any sound settings applied on the 1st NGA-10A will not be carried to the other devices in the chain.

6. Operation

6.1. Safety Instructions for Operation

**Attention**

This device must be used only for the purposes it is designed for.

This device is intended for professional use as an active loudspeaker. It can be used only indoors. This device is not suitable for households.

Any other use, not mentioned under intended use, is regarded as non-intended and incorrect use.

**Attention****Power supply**

Before connecting the device to the power supply, make sure that the current, voltage and frequency match the input voltage, current and frequency specified on the information label on the device.

6.2. Switching On and Off

The device has a power switch.

- To switch the device on, press the **power switch (08)** in ON position.
- To switch the device off, press the **power switch (08)** in OFF position.

6.3. BT Connection

The NGA-10A has an integrated BT receiver with TWS (True Wireless Stereo). You can pair the NGA-10A with a personal computer or a smartphone with BT (a streaming source device) to stream sound. You can also link 2 NGA-10A devices to use them in TWS (True Wireless Stereo) mode.

Refer to the setup example (see [5.2. Setup Example](#) on page 22) for more information on how to connect the devices.

Note:

Make sure that there is clear line of sight between 2 BT devices.

The average effective range between BT devices is 10–30 m. The effective range depends on the receiver sensitivity, the path loss, the interference in the area and the transmitter location. Path loss occurs over distance and is impacted by the environment in which the signal is being transmitted. Sources of interference between the transmitter and the receiver deteriorate the signal.

6.3.1. Pairing with a Streaming Source Device

You can pair the NGA-10A with a streaming source device via BT.

To pair the devices, follow the steps below:

- 01) Press the **BT pairing button (06)**. The LED indicator of the **BT pairing button (06)** starts flashing and the NGA-10A plays a beep sound.
- 02) Switch on the BT functionality on the streaming source device and scan for available BT devices. The default name of the device is NGA-10A. You can change the display name of the device in the menu (see [6.8.8. Speaker and Device Information](#) on page 33).
- 03) Select the NGA-10A from the list of available BT devices and pair the device. When pairing is completed and the devices are connected the LED indicator of the **BT pairing button (06)** illuminates blue and the NGA-10A plays 2 beep sounds.

To terminate the connection with a streaming source device via BT, press and hold down the **BT pairing button (06)** until the LED indicator of the **BT pairing button (06)** turns off and the NGA-10A plays 3 beep sounds. The connection is now terminated.

Notes:

- If no device is paired within 60 seconds after the **BT pairing button (06)** is pushed, the BT connection process is canceled.
- If you switch the device off and on again, the device automatically reconnects to the last connected BT source device. If you want to pair the device to a different streaming source device, you need to terminate the current BT connection.

6.3.2. Linking to Another Device

You can link 2 NGA-10A devices via BT to stream sound in TWS (True Wireless Stereo) mode.

To link 2 devices, follow the steps below:

- 01) Pair the 1st device to a streaming source device (see [6.3.1. Pairing with a Streaming Source Device](#) on page 26).
- 02) Press the **BT link button (05)** on the 1st device. The LED indicator of the **BT link button (05)** starts flashing and the NGA-10A plays a beep sound.
- 03) Press the **BT link button (05)** on the 2nd device. The LED indicator of the **BT link button (05)** starts flashing and the NGA-10A plays a beep sound. When pairing is completed and the devices are linked the LED indicator of the **BT link button (05)** on both devices illuminates blue.

To unlink a device, press and hold down the **BT link button (05)** until the LED indicator of the **BT link button (05)** turns off.

Notes:

- If no device is linked within 60 seconds after the **BT link button (05)** is pushed, the BT connection process is canceled.
- If you switch the device off and on again, the device automatically reconnects to the last linked device. If you want to link the device to a different device, you need to terminate the current BT connection.
- If you unlink a device in stereo mode, the device connected to the streaming source device continues the streaming in mono mode.

6.4. Control Modes

The NGA-10A can be controlled in the following ways:

- With the gain controls (see [6.5. Adjusting the Gain](#) on page 27)
- Through the device menu (see [6.8. Main Menu Options](#) on page 29)
- Through the Sound Control app (see [6.9. App Control](#) on page 35)

6.5. Adjusting the Gain

The device has 3 gain controls for each input, and 1 control for the overall sound level.

Turn the controls to the left/right to respectively increase/decrease the output volume per input channel for the connected signal sources.

- Use the **mic/line-level gain control (13)** to adjust the volume of the **combined mic/line connector IN (12)**.
- Use the **Hi-Z/line-level gain control (14)** to adjust the volume of the **combined Hi-Z/line connector IN (11)**.
- Use the **BT gain control (16)** to adjust the volume of the BT signal.
- Use the **master volume control (04)** to adjust the overall sound balance.

6.6. Start-up

Upon start-up the display shows a splash screen with DAP and the name of the device (see [6.8.8. Speaker and Device Information](#) on page 33):



Immediately afterwards, the display shows the main screen. The main screen displays the following:

- The currently active user mode (see [6.8.2. User Mode](#) on page 30)
- The currently active input delay (see [6.8.5. Delay](#) on page 31)
- The input settings for input 1 and input 2 (see [6.8.1. Input Settings](#) on page 29)
- The status of the input signal (Active/Clip/Error)
- The master gain that is applied to the input signal (see [6.5. Adjusting the Gain](#) on page 27)
- The total output level

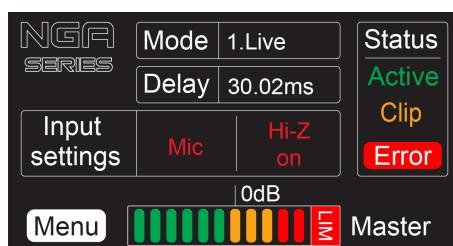

- Turn the **control knob (04)** to adjust the total output level.
- Press the **control knob (04)** to open the Main menu (see [6.8. Main Menu Options](#) on page 29).

6.7. Menu Overview

Level 1	Level 2	Level 3	Level 4	
Input settings (see 6.8.1. Input Settings on page 29)	Input 1	Line Level		
	Input 2	Mic Level		
		Hi-Z mode OFF		
	Hi-Z mode ON			
User mode (see 6.8.2. User Mode on page 30)	Return to main menu			
	Return to main menu			
	Live			
	Monitor			
	Speech			
Subwoofer matching (see 6.8.3. Subwoofer Matching on page 30)	Music			
	Return to main menu			
	No sub/fullrange			
	80 Hz			
	100 Hz			
Equalizer (see 6.8.4. Equalizer on page 31)	EQ1-EQ3	Freq.	19,7–20,16K	
		Q-fac.	0,50–10,1	
		Gain	-12–+6	
		Type	Peak	
			LShelf	
			HShelf	
	Bypass	Bypass		
		Bypass ON		
	Flat	Apply		
		Close		
Delay (see 6.8.5. Delay on page 31)	Return to main menu			
	0.00–20.8 ms			
User preset (see 6.8.6. User Presets on page 32)	Return to main menu			
	0. default			
	1–5	Return to preset menu		
		Load preset		
	Save preset			
Standby amplifier (see 6.8.7. Standby Amplifier on page 33)	OFF			
	5–240 min			
Speaker and device information (see 6.8.8. Speaker and Device Information on page 33)	Device name			
	FW version			
	Return to main menu			
Factory settings reset (see 6.8.9. Factory Settings Reset on page 33)	Apply			
	Close			
Exit menu				

6.8. Main Menu Options

The main menu has the following options:

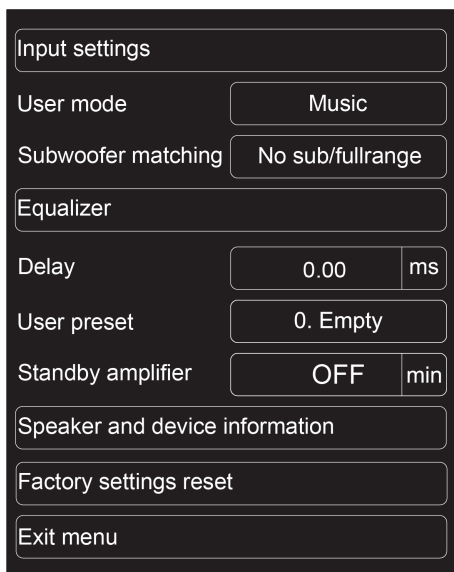

Input settings
User mode
Subwoofer matching
Equalizer
Delay
User preset
Standby amplifier
Speaker and device information
Factory settings reset
Exit menu

- 01) Turn the **control knob (04)** to navigate through the menu.
- 02) Press the **control knob (04)** to open a submenu.
- 03) Select Exit menu and press the **control knob (04)** to return to the main screen.

Note:

In all menus and submenus, if no button is pressed, after 30 seconds of inactivity the device will return to the main screen (see [6.6. Start-up](#) on page 27).

6.8.1. Input Settings

In this menu you can change the settings for the **combined mic/line connector IN (12)** (Input 1) and the **combined Hi-Z/line connector IN (11)** (Input 2).

- 01) Turn the **control knob (04)** to select Input 1 or Input 2.
- 02) Press the **control knob (04)** to confirm the selection.
- 03) Turn the **control knob (04)** to adjust the setting for the selected input:

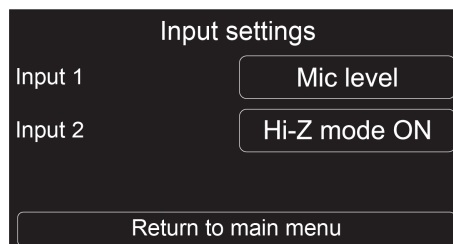

- Input 1: Set the input to Line level or Mic level (see [5.4. Connecting a Line-Level Device](#) on page 23)
 - Input 2: Set the input to Hi-Z mode ON or Hi-Z mode Off (see [5.5. Connecting a Hi-Z Source Device](#) on page 23)
- 04) Press the **control knob (04)** to confirm the setting.
 - 05) Turn the **control knob (04)** to scroll to Return to main menu.
 - 06) Select Return to main menu and press the **control knob (04)** to return to the main menu.

6.8.2. User Mode

In this menu you can select a predefined user mode with preset equalizer settings.

01) Turn the **control knob (04)** to select one of the 4 options:

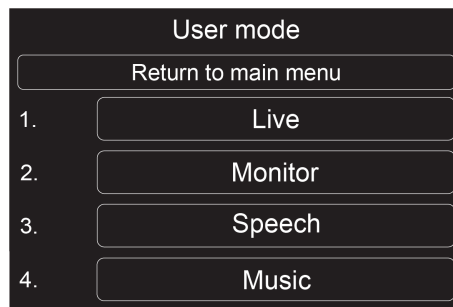

- Live: Use equalizer settings that are ideal for live environments
- Monitor: Use equalizer settings that are ideal for using the device as a monitor
- Speech: Use equalizer settings that are ideal for amplifying speech
- Music: Use equalizer settings that are ideal for playing music

02) Press the **control knob (04)** to confirm the setting.

03) Turn the **control knob (04)** to scroll to Return to main menu.

04) Select Return to main menu and press the **control knob (04)** to return to the main menu.

6.8.3. Subwoofer Matching

In this menu you can set a cutoff frequency to match the sound output with a connected subwoofer (see [5.7. Connecting Multiple Devices](#) on page 24).

01) Turn the **control knob (04)** to select one of the 4 options:

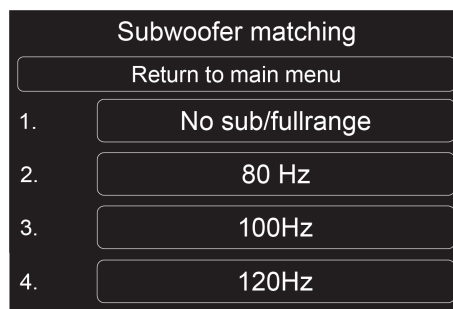

- No sub/full range: Leave all frequencies intact
- 80 Hz: Cut off all frequencies under 80 Hz
- 100 Hz: Cut off all frequencies under 100 Hz
- 120 Hz: Cut off all frequencies under 120 Hz

02) Press the **control knob (04)** to confirm the setting.

03) Turn the **control knob (04)** to scroll to Return to main menu.

04) Select Return to main menu and press the **control knob (04)** to return to the main menu.

6.8.4. Equalizer

In this menu you adjust the 3-band equalizer of the device. You can adjust the frequency, Q factor, gain and waveform type for each equalizer band. Additionally, you can bypass the equalizer or flatten the equalizer settings.

01) Turn the **control knob (04)** to select one of the following options:

	Freq.	Q-fac.	Gain	Type
EQ1	120	0.50	0	Peak
EQ2	1.00K	0.50	0	Peak
EQ3	10.05K	0.50	0	Peak
Bypass				
Flat				
Return to main menu				

- Freq.: Adjust the frequency of EQ band 1, 2 or 3 (19,7–20,16K)
- Q-fac.: Adjust the Q factor of EQ band 1, 2 or 3 (0,50–10,1)
- Gain: Adjust the gain of EQ band 1, 2 or 3 (-12→+6)
- Type: Set the waveform type of EQ band 1, 2 or 3 to peak, low shelf or high shelf (Peak/LShelf/Hshelf)
- Bypass: Bypass the equalizer settings temporarily to go back to the default output signal
- Flat: Flatten the settings for all equalizer bands

02) Press the **control knob (04)** to confirm the setting (for Bypass/Flat) or to confirm the selection (for Freq./Q-fac./Gain/Type).

03) (For Freq./Q-fac./Gain/Type only) Press the **control knob (04)** to confirm the selection.

04) (For Freq./Q-fac./Gain/Type only) Turn the **control knob (04)** to adjust the setting.

05) (For Freq./Q-fac./Gain/Type only) Press the **control knob (04)** to confirm the setting.

06) Turn the **control knob (04)** to scroll to Return to main menu.

07) Select Return to main menu and press the **control knob (04)** to return to the main menu.

6.8.5. Delay

You can set the input delay for the device.

01) In the main menu, turn the **control knob (04)** to select Delay.

02) Press the **control knob (04)** to confirm the selection.

03) Turn the **control knob (04)** to adjust the input delay (0,00–20,8 ms).

04) Press the **control knob (04)** to confirm the setting.

6.8.6. User Presets

In this menu you can save the current equalizer settings for the NGA-10A as a user preset, load a previously saved user preset or delete saved user presets.

Note:

User presets that are stored on the NGA-10A can be used and edited from the menu on the NGA-10A and from the app (see [6.9.2.1. Save/Load](#) on page 37).

01) Turn the **control knob (04)** to select one of the 6 options:

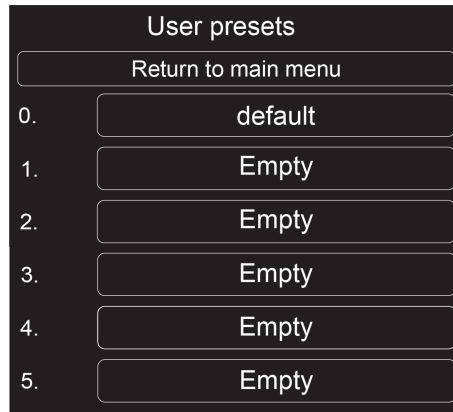

- 0. default: Restore the device to the default settings
- Preset 1–5: Save a new preset to an empty setting or load an existing user preset (see [6.8.6.1. Saving or Loading a User Preset](#))

02) Press the **control knob (04)** to confirm the selection.

03) Turn the **control knob (04)** to scroll to Return to main menu.

04) Select Return to main menu and press the **control knob (04)** to return to the main menu.

6.8.6.1. Saving or Loading a User Preset

In this submenu you can save a new user preset, load an existing user preset or overwrite an existing user preset.

01) Turn the **control knob (04)** to select one of the 2 options:

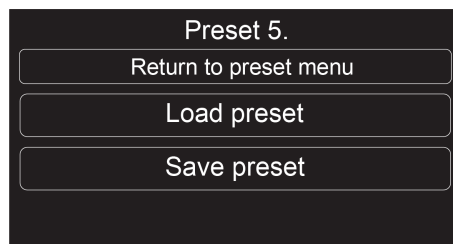

- Load preset: Load an existing user preset (only if a preset has already been saved)
- Save preset: Save or overwrite the equalizer settings to the current user preset

02) Press the **control knob (04)** to confirm the selection.

03) (For Load preset only) Select Apply to load the current user preset or Close to return to the user preset submenu.

04) (For Save preset only) Set the name of the user preset with the keyboard pop-up menu (see [6.8.10. Onscreen Keyboard](#) on page 34).

05) Turn the **control knob (04)** to scroll to Return to preset menu.

06) Select Return to preset menu and press the **control knob (04)** to return to User Presets (see [6.8.6. User Presets](#)).

6.8.7. Standby Amplifier

You can adjust the standby time of the device. After the standby time, the device powers off automatically.

- 01) In the main menu, turn the **control knob (04)** to select Standby Amplifier.
- 02) Press the **control knob (04)** to confirm the selection.
- 03) Turn the **control knob (04)** to adjust the setting:
 - OFF: Keep the device always on
 - 05–240 min: Set the standby time in increments of 5 minutes
- 04) Press the **control knob (04)** to confirm the setting.

6.8.8. Speaker and Device Information

In this menu you can set the name of the device and view the current firmware version of the device.

Note:

The name of the device is shown on the startup screen. It is also shown when connecting a source device through BT (see [6.3. BT Connection](#) on page 25) or when setting up the NGA-10A in the app (see [6.9.1. Connecting the Device](#) on page 35).

- 01) Turn the **control knob (04)** to select one of the 2 options:

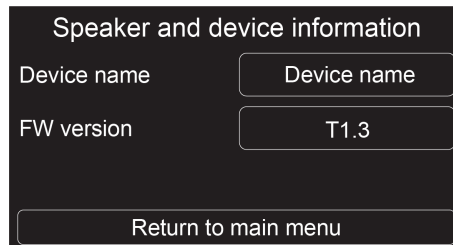

- Device name: Set the name of the device
 - FW version: View the current firmware version of the device
- 02) (For Device name only) Press the **control knob (04)** to confirm the selection.
 - 03) (For Device name only) Set the name of the device with the onscreen keyboard (see [6.8.10. Onscreen Keyboard](#) on page 34).
 - 04) Turn the **control knob (04)** to scroll to Return to main menu.
 - 05) Select Return to main menu and press the **control knob (04)** to return to the main menu.

6.8.9. Factory Settings Reset

You can reset all settings of the NGA-10A to the default factory settings.

- 01) In the main menu, turn the **control knob (04)** to select Factory settings reset.
- 02) Press the **control knob (04)** to confirm the selection.
- 03) In the pop-up submenu that appears, select one of the 2 options:

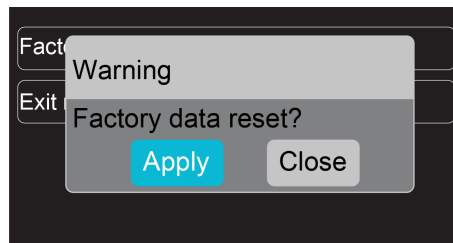

- Apply: Reset the factory settings and return to the main menu
 - Close: Leave the current settings unchanged and return to the main menu
- 04) Press the **control knob (04)** to confirm the selection.

6.8.10. Onscreen Keyboard

In several menus of the NGA-10A you can create or edit a name with an onscreen keyboard.

01) Turn the **control knob (04)** to select a letter, a punctuation mark, or one of the following options:

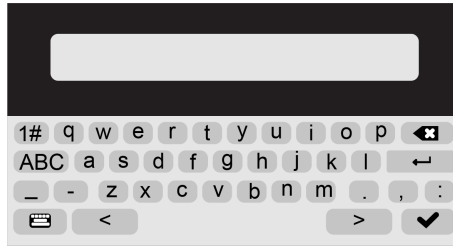

- 1#: Switch the keyboard to numbers and punctuation marks. Select abc to return to letters
- ABC: Switch to uppercase mode. Select abc to return to lowercase mode
- Keyboard icon: No function
- Backspace icon: Delete the character before the cursor
- Return icon: No function
- < and > icon: Move the cursor left or right

02) Press the **control knob (04)** to confirm the selection.

03) Select the check mark in the bottom right and press the **control knob (04)** to confirm the entered name and return to the previous menu.

6.9. App Control

The NGA-10A can be controlled through the Sound Control DSP app.

To connect the device to the app, follow the steps below:

- 01) Install the Sound Control DSP app on your Android or iOS device.
- 02) Pair your Android or iOS device to the NGA-10A through BT (see [6.3.1. Pairing with a Streaming Source Device](#) on page 26).
- 03) Connect your NGA-10A to the Sound Control DSP app (see [6.9.1. Connecting the Device](#)).

6.9.1. Connecting the Device

To connect a NGA-10A device in the Sound Control DSP app, follow the steps below:

- 01) Open the Sound Control DSP app on your Android or iOS device.
- 02) Press the Refresh button in the top right corner to search for all available BT devices.
- 03) Tap the device you want to control.
- 04) Tap the Connect button to connect the device to the app and open the main menu (see [6.9.2. Main Menu](#) on page 36).

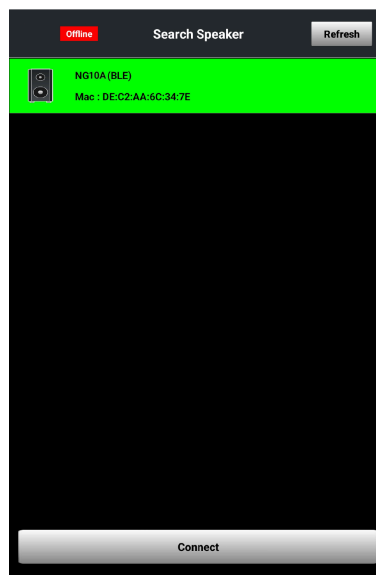

6.9.2. Main Menu

In the main menu of the app you can adjust the main output volume of the NGA-10A, open the Save/Load menu for user presets, mute the output of the device, open the equalizer settings of the device or reset the device to the factory settings.

Tap a button to activate the function or open the submenu:

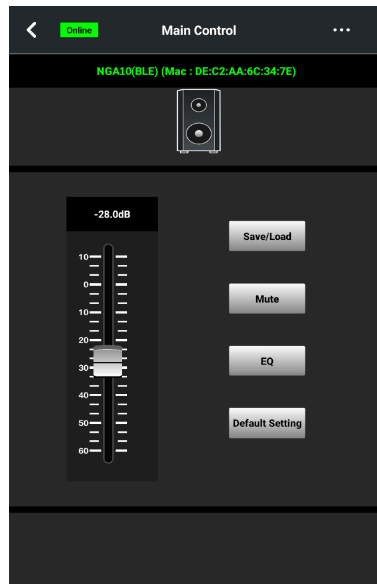

- Volume slider: Adjust the output volume of the device (-60–10,0 dB)
- Save/Load: Open the Save/Load menu (see [6.9.2.1. Save/Load](#))
- Mute: Mute the output of the device
- EQ: Open the equalizer settings (see [6.9.2.2. EQ Setting](#))
- Default Setting: Reset the device to the default factory settings (No/Yes)

6.9.2.1. Save/Load

In this menu you can save the current equalizer settings for the NGA-10A as a user preset (see [6.9.2.1.1. Save a User Preset](#)), load a previously saved user preset (see [6.9.2.1.2. Load a User Preset](#)) or delete saved user presets (see [6.9.2.1.3. Delete a User Preset](#)). User presets can be stored locally in the app or on the NGA-10A.

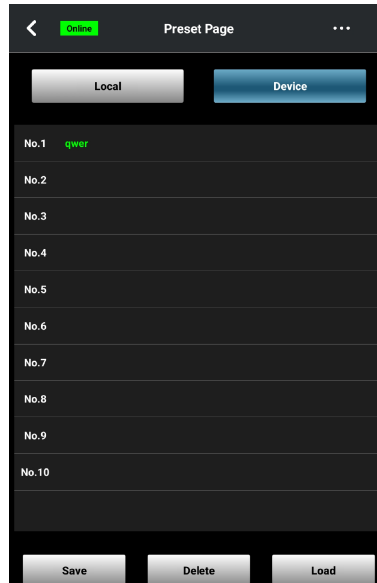

Note:

User presets that are stored on the NGA-10A can be used and edited from the app and from the menu on the NGA-10A (see [6.8.6. User Presets](#) on page 32). User presets that are stored locally in the app can only be used or edited from the app.

6.9.2.1.1. Save a User Preset

To save a new user preset, follow the steps below:

- 01) Press Local to see the user presets stored in the app or press Device to see the user presets stored on the device.
- 02) Select an existing user preset to overwrite it or select an empty user preset to save a new user preset.
- 03) Press the Save button to open the Save Preset pop-up submenu.
- 04) Enter a name for the user preset.
- 05) Press Save to save the user preset or press Cancel to go back to the Save/Load menu.

6.9.2.1.2. Load a User Preset

To load a previously saved user preset, follow the steps below:

- 01) Press Local to see the user presets stored in the app or press Device to see the user presets stored on the device.
- 02) Select an existing user preset.
- 03) Press the Load button to open a confirmation pop-up submenu.
- 04) Press YES to load the user preset or press NO to go back to the Save/Load menu.

6.9.2.1.3. Delete a User Preset

To delete a previously saved user preset, follow the steps below:

- 01) Press Local to see the user presets stored in the app or press Device to see the user presets stored on the device.
- 02) Select an existing user preset.
- 03) Press the Delete button to open a confirmation pop-up submenu.
- 04) Press YES to delete the user preset or press NO to go back to the Save/Load menu.

6.9.2.2. EQ Setting

In this menu you can do the following:

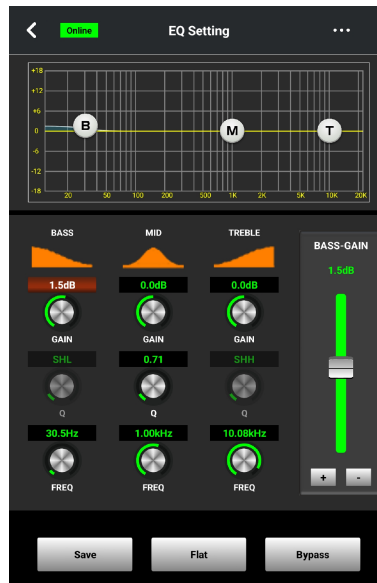

- Waveform icon: Adjust the filter slope for the bass, mid and treble equalizer band (Low shelf/Peak/High shelf)
- Gain: Adjust the gain for the bass, mid and treble equalizer band (-18,0–+18,0 dB)
- Q: Adjust the Q factor for the bass, mid and treble equalizer band (0,4–128,0)
- Freq: Adjust the frequency of the bass, mid and treble equalizer band (19,7 Hz–20,16 kHz)
- Save: Save the current equalizer settings as a user preset. This button opens the Save/Load menu (see [6.9.2.1. Save/Load](#) on page 37)
- Flat: Flatten the settings for all equalizer bands
- Bypass: Bypass the equalizer settings to leave the input signal unchanged

To adjust the filter slope for an equalizer band, tap the waveform icon to cycle through the following options:



- Low shelf: Boost or cut only the frequencies below the frequency set for the current equalizer band
- Peak: Boost or cut a narrow band of frequencies around the frequency set for the current equalizer band
- High shelf: Boost or cut only the frequencies above the frequency set for the current equalizer band

To adjust the gain, Q factor or frequency for an equalizer band, follow one of the steps below:

- Press the Gain control knob in the equalizer band column and drag the slider on the right up or down
- Press the Gain control knob in the equalizer band column and press and hold + or - underneath the slider on the right
- Press and hold the Gain control knob in the equalizer band column and drag up or down
- Press and hold the B, M or T in the equalizer graph and drag one of the 3 points (B, M or T) up or down (for gain) or left or right (for frequency)

Note:

The Q factor can only be adjusted for an equalizer band if the peak filter slope is active.

7. Troubleshooting

This troubleshooting guide contains solutions to problems which can be carried out by an ordinary person. The device does not contain user-serviceable parts.

Unauthorized modifications to the device will render the warranty void. Such modifications may result in injuries and material damage.

Refer servicing to instructed or skilled persons. Contact your Highlite International dealer in case the solution is not described in the table.

Problem	Probable cause(s)	Solution
The device does not function at all	No power to the device	<ul style="list-style-type: none"> Make sure that the device is connected to the power supply and switched on
	Main fuse is blown	<ul style="list-style-type: none"> Replace the fuse (see 8.3.1. Replacing the Fuse on page 42)
No sound	Devices are not paired	<ul style="list-style-type: none"> Make sure that the device is paired with any external device
	Bad connections	<ul style="list-style-type: none"> Make sure that the connections between the device and the external devices are correct and not defective
BT playback is not functional	There is no connection to the streaming source device	<ul style="list-style-type: none"> Make sure that the BT functionality on the streaming device is turned on and the devices are paired
	The device is still paired to a different streaming source device	<ul style="list-style-type: none"> Terminate the previous connection and pair the device with the current streaming source device (see 6.3.1. Pairing with a Streaming Source Device on page 26)
	The streaming source device is out of range	<ul style="list-style-type: none"> Move the streaming source device closer or remove any obstructions between the device and the streaming source device
	BT source volume is off/low	<ul style="list-style-type: none"> Make sure BT source device is not muted and the volume is turned up

8. Maintenance

8.1. Safety Instructions for Maintenance



DANGER
Electric shock caused by dangerous voltage inside

Disconnect power supply before servicing or cleaning.

8.2. Preventive Maintenance



Attention
Before use, examine the device visually for any defects.

Make sure that:

- The housing is not damaged.
- The power cable is not damaged and does not show any material fatigue.

8.2.1. Basic Cleaning Instructions

To clean the device, follow the steps below:

- 01) Disconnect the device from the electrical power supply.
- 02) Allow the device to cool down for at least 5 minutes.
- 03) Clean the device with a soft, lint-free cloth.



Attention

- Do not immerse the device in liquid.
- Do not use alcohol or solvents.

8.3. Corrective Maintenance

The device does not contain user-serviceable parts. Do not open the device and do not modify the device.

Refer repairs and servicing to instructed or skilled persons. Contact your Highlite International dealer for more information.

8.3.1. Replacing the Fuse



DANGER
Electric shock caused by short-circuit

- Do not bypass the thermostatic switch or fuses.
- Replace fuses only with the same type and rating.

Power surges, short-circuit or incorrect electrical power supply may cause a fuse to burn out. If the fuse burns out, the device will not function anymore. If this happens, follow the steps below:

- 01) Disconnect the device from the electrical power supply.
- 02) Allow the device to cool down for at least 15 minutes.
- 03) Pry up the fuse holder, integrated in the power connector, with a flat-blade screwdriver.
- 04) If the fuse is brown or unclear, it is burned out. Remove the old fuse.
- 05) Insert a new fuse in the fuse holder. Make sure that the type and the rating of the replacement fuse are the same as the ones specified on the information label of the product.
- 06) Replace the fuse holder in the opening and push it gently back in place.

9. Deinstallation, Transportation and Storage

9.1. Instructions for Deinstallation



WARNING

Incorrect deinstallation can cause serious injuries and damage of property.

- Let the device cool down before dismounting.
- Disconnect power supply before deinstallation.
- Always observe the national and site-specific regulations during deinstallation and derigging of the device.
- Wear personal protective equipment in compliance with the national and site-specific regulations.

9.2. Instructions for Transportation

- Use the original packaging to transport the device, if possible.
- Always observe the handling instructions printed on the outer carton box, for example: "Handle with care", "This side up", "Fragile".

9.3. Storage

- Clean the device before storing (see [8.2.1. Basic Cleaning Instructions](#) on page 41).
- Store the device in the original packaging, if possible.

10. Disposal

Correct disposal of this product

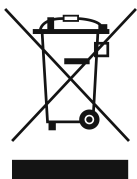

Waste Electrical and Electronic Equipment

This symbol on the product, its packaging or documents indicates that the product shall not be treated as household waste. Dispose of this product by handing it to the respective collection point for recycling of electrical and electronic equipment. This is to avoid environmental damage or personal injury due to uncontrolled waste disposal. For more detailed information about recycling of this product contact the local authorities or the authorized dealer.

11. Approval



Hereby, Highlite International declares that the device NGA-10A, product code D3557, is in compliance with Directive 2014/53/EU (RED – Radio Equipment Directive).

The full text of the EU declaration of conformity is available on the respective product page on the website of Highlite International (www.highlite.com).

DAP